

x2

# MANUAL

## CAT BENCH 100x65x60cm



www.duvoplus.com

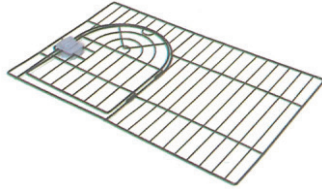

Front Panel x 1

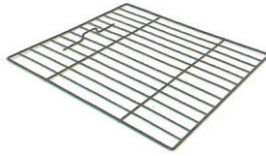

Side Panel x 2

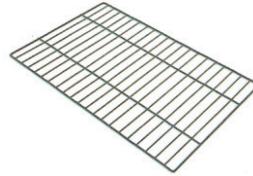

Back Panel x 1



Top Panel x 1

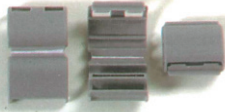

Single Buckle



Double Buckle



Corner Clasps

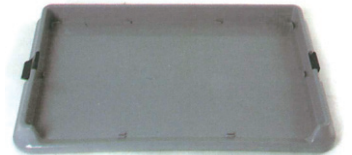

Base

1

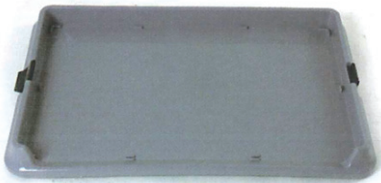

Base

2

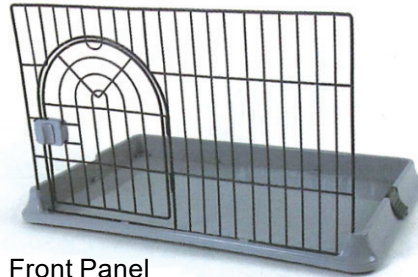

Front Panel



Clamp the mesh in the slot of the base

3



Side Panel



Add the side piece with horizontal bar  
Steel wire facing outward and in the  
same horizontal line

Double Buckle

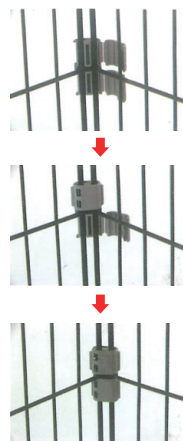

4



Back Panel



Double rows of  
clasps are secured

5



Side Panel

Corner Clasps



6

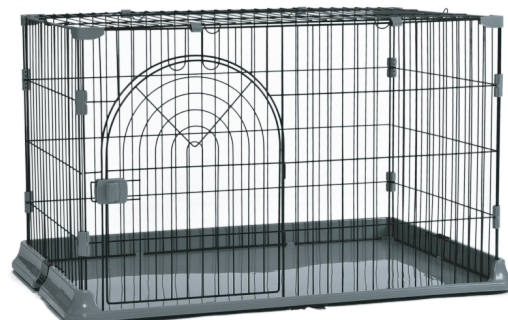

Top Panel  
Single Buckle